



**CITY OF LINCOLN CITY  
PARKS & RECREATION ADVISORY BOARD AGENDA**

**Wednesday, April 15, 2026, 2:30 p.m.**

**Community Center - Big Room**

**2150 NE Oar Place**

**Lincoln City, OR 97367**

The meeting location is accessible to persons with disabilities. An accessible restroom is available on the first floor. A request for an interpreter for the hearing impaired, for a hearing-impaired device, or for other accommodations for persons with disabilities, should be made at least 48 hours in advance of the meeting. To request information in an alternate format or other assistance, please contact the City's ADA Coordinator, Kevin Mattias, at [541-996-1221](tel:541-996-1221) or [kmattias@lincolncity.org](mailto:kmattias@lincolncity.org). Visit <https://www.lincolncity.org/residents/ada-accessibility> webpage to view how the City continues to remain in compliance with Title II of the Americans with Disabilities Act regarding City programs, services, processes, and facilities.

The Parks & Recreation Advisory Board reserves the right to add or delete items as needed, change the order of the agenda, and discuss any other business deemed necessary at the time of the meeting.

Agenda materials for this meeting are available at [www.lincolncity.org/publicmeetings](http://www.lincolncity.org/publicmeetings).

This Meeting is open to the Public.

---

**A. CALL TO ORDER**

**B. MINUTES**

**Approve Minutes from the March 18, 2026 meeting.**

**C. PRESENTATIONS**

**D. PARKS & RECREATION STAFF REPORTS**

**April 2026 City Council Report - March updates**

**E. PARKS & RECREATION BUDGET UPDATE**

1. Update on 2026-2027 Budget preparation

2. Transient Room Tax (TRT)

a. The citizens of Lincoln City approved an increase in the City TRT from 9.5% to 12% effective July 1, 2023.

b. Chart of TRT funds utilized in LC

i. ELC's funding support of our citywide park wayfinding system, SCDP playground, hearing loops, kayak launch, Mobi-mats, etc.

**F. UNFINISHED BUSINESS**

1. System Plan Review and Revisions

a. Projects Completed - draft

- b. Projects Outstanding - draft
- c. 2026 System Plan Amendment - draft
- 2. Sponsorship Updates
- 3. PrideFest – Board should arrive at 9:45 a.m. on 6/27
- 4. SCDP Phase 3 planting list and plan
  - a. The plants next to the field/streets are shade trees, not selected yet. Understory is aware we'd like visibility from the street (i.e. higher leaf placement). A reminder these are both shade and noise buffers.
- 5. Update on Regatta Sandcastle presentation to City Council on 3/23/26
- 6. LCP&R Board presentation to City Council - 6/22/26
- 7. CHBC Sand Art Event (8/15/26) Theme - Climate Change and the Ocean

**G. PARKS & RECREATION PROJECTS - BOARD INPUT**

**H. NEW BUSINESS**

**I. BOARD MEMBER COMMENTS**

**J. ADJOURN**



**CITY OF LINCOLN CITY**  
**PARKS & RECREATION ADVISORY BOARD**  
**MINUTES OF THE MEETING**

**March 18, 2026, 2:30 p.m.**

Board Members Present: Jane Mulholland - Board Chair  
Donna Eddy - Board Member  
Joan Prins - Board Member  
Shawn Wood - Board Member  
Beth Towers - Board Member  
Stephen Percy - Board Member

Board Members Absent: Robert Vincent - Board Member  
Ava Graves - Youth Board Member  
Maya Freschi - Youth Board Member

Staff Present: Jeanne Sprague - Parks & Recreation Director  
Diane Robson - Executive Assistant to the  
Parks & Recreation Director

---

**A. CALL TO ORDER**

Chair Mulholland called the meeting to order at 2:30 p.m.

**B. MINUTES**

Chair Mulholland asked if there were any corrections or additions to the 2/18/26 minutes presented for approval. There were none. Chair Mulholland called for a motion. Board member Percy moved to accept the minutes. Board member Prins seconded the motion. There was no further discussion. The motion was approved.

**Motion: Approval of February 2026 Minutes**

**Moved by:** Stephen Percy - Board Member

**Seconded by:** Joan Prins - Board Member

Ayes (6): Jane Mulholland - Board Chair, Donna Eddy - Board Member, Joan Prins - Board Member, Shawn Wood - Board Member, Beth Towers - Board Member, and Stephen Percy - Board Member

Absent (3): Robert Vincent - Board Member, Ava Graves - Youth Board Member, and Maya Freschi - Youth Board Member

**Motion: Passed by Voice Vote (6 to 0)**

**C. PRESENTATIONS**

There were no presentations.

**D. PARKS & RECREATION STAFF REPORTS**

The staff report presented to the City Council in March (re: February) was discussed. Chair Mulholland noted a correction to be made under the LCP&R Grant Team section, second bullet point. It should have said \$104k.

**E. PARKS & RECREATION BUDGET UPDATE**

Director Sprague has had several meetings with the Finance Director and the City Manager while preparing the FY 2026-2027 budget. They will meet and then present the proposed budget at a City Council meeting in the Spring. Director Sprague let the Board know that all departments are facing cuts this year, due to a variety of issues. The issues specifically affecting Parks and Recreation include reductions in receipts from Marijuana Tax and Transient Room Tax (TRT). The Board discussed P&R's budget not being in the City's General Fund. In addition to the Marijuana and TRT tax, other revenue sources for P&R include a small percentage of System Development Charges (SDC) and Community Center revenue, along with any grant money received. Director Sprague gave a brief explanation of how TRT money is divided between city departments. She also explained how the budget cuts were proposed within the department, which include an 8% across-the-board increase to fees, postponing the purchase of some park equipment: a truck and a gator. New parks projects will also be on hold, although as-needed maintenance will continue. The proposed cuts do not include cuts to the Community Center hours, or to Parks and Recreation staff.

We will also need to review and revise the policies related to waiving fees for non-profit use of our parks and facilities.

**F. UNFINISHED BUSINESS**

1. The approach to the review and update to the System Plan was discussed. Ideas for recreation programming will be included.
2. On 3/23/26, Director Sprague will give a presentation to City Council on the Regatta Park Sandcastle Playground design, grading and budget. The presentation was briefly discussed and Board members provided feedback.
3. The LCP&R Board will prepare for their annual presentation to City Council and various items to include were discussed. Chair Mulholland suggested that the presentation should be on 6/8/26. Director Sprague will arrange to get it on the City Council Agenda.
4. Creation of an LCP&R Board team for the CHBC Sand Art event was discussed. Chair Mulholland and Board member Towers volunteered to be on the team. LCP&R staff will also have a team. There will be more discussion closer to the event.
5. The Board reviewed the new Skatepark sign that will be installed soon and voted to accept the design.
6. Director Sprague and Board member Prins gave an update on the meetings they have had with potential sponsors for SCDP. A sponsorship package was passed out to each Board member.

**Motion: Approval of design for new Skatepark sign**

**Moved by:** Stephen Percy - Board Member

**Seconded by:** Shawn Wood - Board Member

Ayes (6): Jane Mulholland - Board Chair, Donna Eddy - Board Member, Joan Prins - Board Member, Shawn Wood - Board Member, Beth Towers - Board Member, and Stephen Percy - Board Member

Absent (3): Robert Vincent - Board Member, Ava Graves - Youth Board Member, and Maya Freschi - Youth Board Member

**Motion: Passed by Voice Vote (6 to 0)**

**G. PARKS & RECREATION PROJECTS - BOARD INPUT**

There was no further Board input on P&R projects.

**H. NEW BUSINESS**

The video from the Governor's Conference on Travelability was viewed.

**I. BOARD MEMBER COMMENTS**

Board member Prins expressed concerns about the trees bordering the field at SCDP limiting visibility. Director Sprague will get more information on what type of trees are planned and will bring it to the next meeting.

**J. ADJOURN**

Chair Mulholland adjourned the meeting at 4:01 p.m.

## **April 2026 City Council Report – March 2026 updates**

### **LC Parks & Recreation updates for FY 25-26:**

- Schooner Creek Discovery Park (SCDP):
  - Phase 2 construction is near completion. Final vegetation was planted in Feb 2026.
  - Phase 3 design is in process, with funding secured and cost approved by Council. Final design with final amendment will be presented to Council on 4/20/26.
- Sandcastle Playground new design:
  - In progress – 80% design completed. Planning on finalizing design, and putting a hold on construction while completing SCDP.
- LCP&R Grant Team:
  - Submitted 3 grants in March 26.
- NEW projects being worked on for accessibility in LC:
  - RightHear – app for vision impaired, planning for utilization in SCDP.
  - Hearing Loops at SCDP.
  - Universal Changing Table at SCDP restrooms – installed.
  - Enchroma viewfinders at access points – working on.
  - Accessible kayak launch at Regatta Park: Travel OR has funded \$50k. Still applying for more alternative funding.
- Hosting/partnering on 5 public events during our annual Community Days celebration, week of 4/18-25. Be on the lookout for marketing of these events!
- Kirtsis Park fields open for play! Dog Park improved, with new entrance walkway and fencing.
- 92 people came out for the Lucky Leprechaun 5k- Mar 21, 10am at 40<sup>th</sup> St. Beach Access.
- Spring Propagation Fair- Mar 28, at the Lincoln City Community Center
  - Over 700 plants were taken home (or shared) by 300+ people that attended this native plant event. Thanks to Tillamook Estuaries Partnership, Mid Coastal Watershed Council, OSU Food Hero, Driftwood Library, Connie Hanson Gardens & the Worm Lady for helping people with questions and support!

### **LC Parks & Recreation Board updates**

- Next mtg is 4/15/26, 2:30-4pm at Community Center
- Current focus of Board:
  - Continued alternative funding ideas of Schooner Creek Discovery Park.
  - Making the 2026 Board recommendations of the 2016 LCP&R System plan. Will be utilizing the 2021 Board recommendations for this, and presenting to Council on 6/22/26.

**Memberships and usage at Community Center –**



**March 2026**

Metrics	FY 24-25	FY 25-26	% Change	Other
Membership Net Revenue	\$16,051	\$16501.66	2.8%	Total sales minus \$2879.45 in refunds to annual memberships that moved to Silver Sneakers
Membership Usage	5,200	5,051	(2.87)%	
New Members	196	245	25%	
Retention Rate	97.28%	96.11%	(1.2)%	
Drop-ins and punch pass Usage	2,428	2,227	(8.28)%	
Drop-ins and punch pass Revenue	\$12,465	\$12,330	(1.08)%	
YAC Members	180	206	14.44%	
Total Members	1,685	1,957	16.14%	
Notes				Memberships continue to grow providing a steady revenue stream over drop-in usage,

## What do Transient Room Tax Revenues Fund?

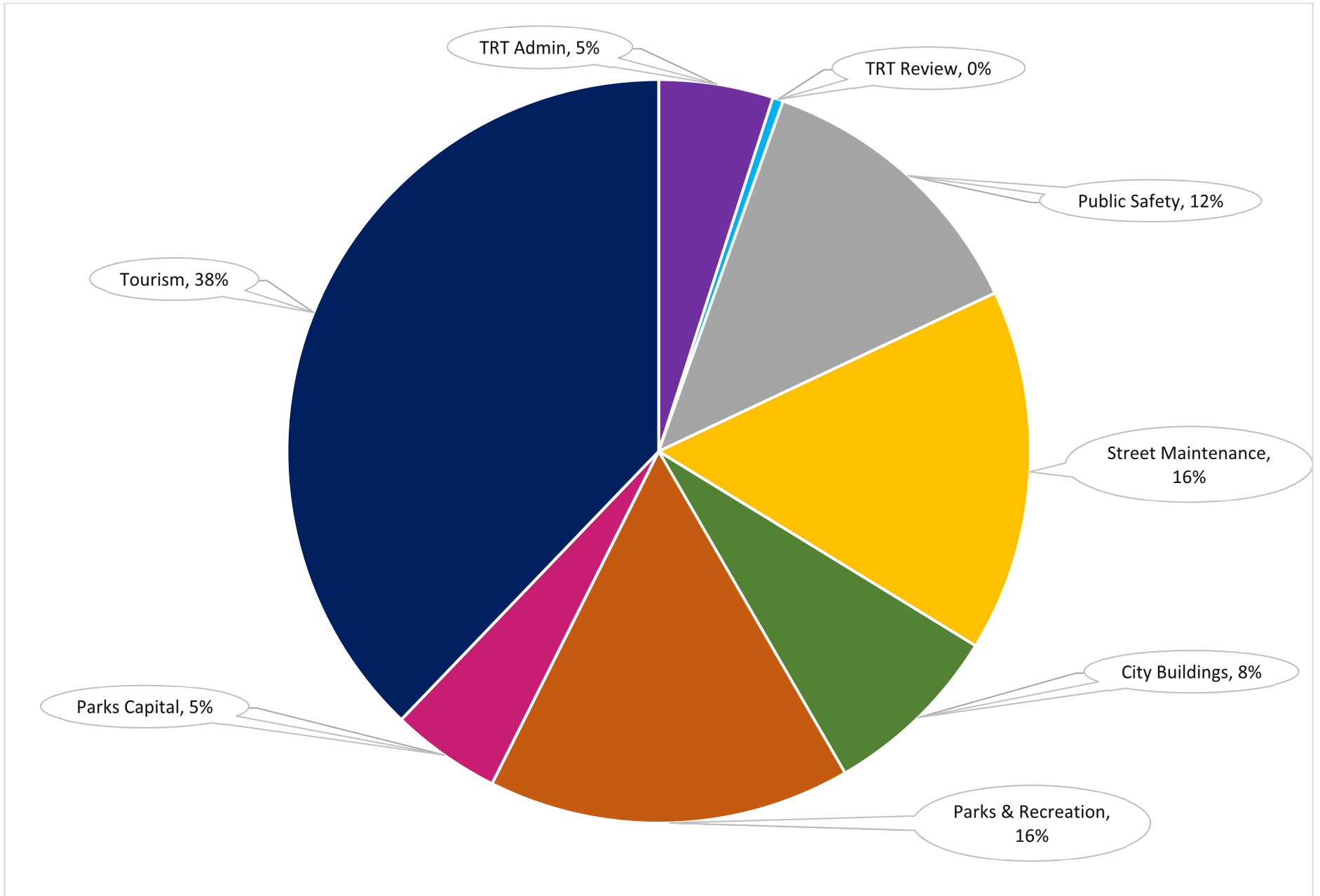

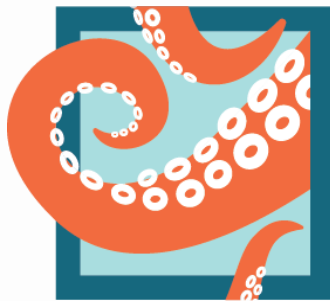

# **PARKS & RECREATION**

## **LINCOLN CITY**

### **Lincoln City Parks & Recreation System Plan Projects Completed**

**Since 2021 Amendment (as of April 2026)**

**DRAFT**

#### **Financial and Key Metrics:**

##### **Expense Recovery Provided by Recreation Fees:**

- Fees increased in 2022, 2024 and 2025; will increase again 7/1/26
- Fees becoming more aligned with budgetary needs

##### **Capital Projects - Deferred Maintenance:**

###### **Beach Accesses:**

- NW 15th St - restrooms and bollards repaired, new railing for entire hill
- NW 35<sup>th</sup> (Grace Hammond Wayside)- asphalt to beach (ADA) completed

###### **Community Center:**

- New roof installed
- Swimming pool re-tiled
- New HVAC System installed

###### **Open Spaces/Trails:**

- Open Space trail remediation – for all 9 trails
- Trail naming signage completed
- The Knoll – replaced gates and added trail numbers

**Parks:**

- Regatta Park Sandcastle Playground:
  - Design-Build Team hired in 2024. Public outreach for design completed in May 2024. Design at 90% completion.
- Dorchester Courts- resurfaced courts; removed invasives
- Kids Park – replaced fencing (half)
- Kirtsis Park - paved parking lot and new fencing
- Skate Park - completed \$20K of bowl repairs (of \$100k)
- Siletz Bay Park- repaired gazebo

**Public Restrooms (29):**

- Metal Doors - replaced 10 of 29 (approx. \$6K each)
- Restrooms - painted 5 of 29 (approx. \$7K each)
- NW 17<sup>th</sup> St – complete tear down and new restroom built – completed 11/2025
- SW 50<sup>th</sup> St - new urinal

**Capital Projects – New Ammenities completed:**

- Cameras installed at Kirtsis Park and SW 51<sup>st</sup> St
- Community Center Pocket Park (Cornhole)
- Community Center - kitchen upgrade
- Community Center - gym exterior painted
- Community Center - fire and security alarm upgrade
- Dock repair – at SE Tide Ave (off SE 3<sup>rd</sup> St)
- Dog Park
- Ed Johann Veterans Plaza
- Holmes Road Park – new life jacket stand
- Mobi-mat purchases
- Nesika Park – trail and story circle built with signage
- Native Plantings - 27,000 plants and shrubs installed at SCDP
- Pollinator Plaza
- Senior Center parking lights
- Siletz Bay Park - new roof on gazebo
- Schooner Creek Discovery Park (previously Taft Park)
  - Phase I - inclusive and accessible playground built – opened 12/2024
  - Phase II - design completed; construction in process
  - Phase III - design in process; construction expected to be completed by EOY 2026
- Signage – new signage for Beach Accesses, Parks and Open Spaces/Trails
- Trash cans – new cans throughout City
- Wayfinding signs
- Zero maintenance rock project on park strips in Nelscott



# **PARKS & RECREATION**

## **LINCOLN CITY**

### **Lincoln City Parks & Recreation System Plan**

#### **Project Outstanding**

Since 2021 Amendment

**DRAFT**

### **Financial and Key Metrics:**

#### **Capital Projects - Deferred Maintenance:**

##### **Beach Accesses:**

- NW 35th (Grace Hammond Wayside) - resurface parking lot and improve parking
- NW 50<sup>th</sup> - paving, repair
- NW 64<sup>th</sup> - paving, ADA access
- SW 65<sup>th</sup> St (Josephine Young) - repair restroom, concrete tables, reinforce concrete landing, build ADA access to beach

##### **Community Center:**

- Community Center - new irrigation
- Community Center Park - resurface basketball court

##### **Open Spaces/Trails:**

- Spring Lake Open Space
  - ADA investments
  - Property easement to formalize existing (informal) trail on North side of open space

**Parks:**

- Holmes Road Park - replace stairs; consider adding other amenities
- Kids Park – finish fencing, new entrance, new irrigation, replace playground equipment, repair/replace court
- Regatta Park - new plastic bumpers lining road
- Regatta Park Sandcastle Playground:
  - Built in 1992. Expected lifespan of 20 years. Inspection completed in 2014.
  - Design-Build Team hired in 2024. Public outreach for design completed. Design at 90% completion. Budget not set. Construction date not set.
- Sandpoint Park - rebuild ramp
- Skate Park - bowl repairs ongoing (completed \$20k of repairs); replace roof
- Wecoma Park- remodel court (restrooms are closed permanently due to pump station disfunction)

**Public Restrooms (29):**

- 19 of 29 metal doors left to replace (approx. \$6k each)
- 20 of 29 restrooms left to paint (approx. \$7K each)
- SW 50<sup>th</sup> St restroom - replace roof (recommend complete overhaul)

**Capital Projects – New Amenities:**

- Canyon Park
  - Add picnic area/tables to the Park
  - Develop trail to Agnes Creek Open Space, about ¼ mile, to connect the Open Space with the beach
    - Trail building “party” organized by a “Friends of” group
- Kirtsis Park -
  - ADA improvements
  - Develop a connector trail system to NE West Devils Lake Blvd
- Nesika Park - \$1,575,000 to develop property (estimate by landscape architect)
  - No design on this
  - Create Disc Golf Course
- Regatta Park – (not including the Sandcastle Playground replacement project) other key investments needed at Regatta Park include:
  - Programming for new stage and amphitheater (post COVID-19)
  - Native plant restoration coupled with invasive species removal as a targeted community involvement project

- Schooner Creek Discovery Park (previously Taft Park)
  - Phase II - design completed; construction in process
  - Phase III - design in process; construction expected to be completed by EOY 2026
  
- Taft Bayfront Park
  - ADA improvements
  - SW 51<sup>st</sup> St gazebo - now under the purview of Urban Renewal
  
- Wecoma Park
  - Concrete wall removal to allow full court games
  - ADA improvements

**Longer Term Capital Needs (6+ years):**

- Community Center Replacement - \$15,000,000 - \$20,000,000

**Miscellaneous:**

- Geocaching program - institute [policy](#) developed by Portland Parks and Rec for:
  - Agnes Creek Open Space
  - Spyglass Ridge Open Space



# **PARKS & RECREATION**

## **LINCOLN CITY**

### **Lincoln City Parks & Recreation System Plan**

#### **Parks & Recreation Board Perspective**

**XXXX** 2026 Amendment

**DRAFT**

#### **LC Parks and Recreation Board**

Jane Mulholland, Chair

Donna Eddy

Stephen Percy

Joan Prins

Beth Towers

Robert Vincent

Shawn Wood

Maya Freschi

Ava Graves

#### **LC Parks and Recreation Director**

Jeanne Sprague

#### **LC Parks and Recreation Executive Assistant**

Diane Robson

## Document Organization – update after final review/edits made

Purpose	2
Goals	2
Parks and Recreation Mission Statement	2
Executive Summary	3
Financial and Key Metrics	4
Recreation Fees	7
Deferred Maintenance and Implications	8
Short Term Capital Needs (1-5 years)	8
Longer Term Capital Needs (6+ years)	9
Path Forward	9

### Purpose

The purpose of this document is to inform the City Council about the status of Lincoln City Parks and Recreation (LCP&R) funding for short- and long-term capital requirements.

### Goals

1. To provide clarity on current funding for Parks and Recreation.
2. To inform Council members about short (and longer term) capital needs to achieve Council and community objectives.
3. To serve as a basis for discussion regarding the Parks and Recreation system's ability to meet community expectations now and into the future.

### Parks and Recreation Mission Statement

The mission of the Lincoln City Parks and Recreation Department is to enhance the quality of life and provide safe and accessible services, programs, and facilities for all.

## Executive Summary –

The Parks and Recreation System Plan was released in early 2016.

The Vision & Goals noted in the plan were as follows:

*The city of Lincoln City and its community members will strive to create a park and recreation system that:*

- *Is well-connected and accessible, featuring a geographically dispersed set of facilities and an interconnected, easily navigable system of trails, pathways and other opportunities to travel to facilities by walking, bicycling, driving and transit.*
- *Is inclusive and culturally sensitive, providing opportunities for people of all ages and backgrounds, including young people, families, older adults, and people with limited means.*
- *Celebrates and preserves nature and enhances the ecological integrity of Lincoln City's natural areas.*
- *Continues to provide access to Lincoln City's expansive beaches and waterways.*
- *Is enticing and safe and provides a diverse range of indoor and outdoor recreational activities, including opportunities for education, active recreation, and enjoyment of nature.*
- *Responds to current and future needs and includes existing, new and enhanced facilities that are modern, inviting, well-maintained, designed and operated sustainably, and include adequate parking and other amenities and attractions for both residents and visitors.*
- *Supports and grows our economic base of tourism.*
- *Is ambitious, but realistic, and can be implemented by the city, in partnership with other community members and organizations.*

Page 2 of that plan highlighted a reality that, in large part, exists to this day:

“Although the city has a great wealth of resources, the Parks Board is frustrated by the lack of progress since the adoption of the 2001 Master Plan in meeting the core needs of local residents for parks and recreation facilities in their neighborhoods, especially in south Lincoln City, and in meeting unmet needs of children and teens. Officials also recognize that the city must enhance parks, open spaces and facilities in order to maximize their recreation value for residents and visitors.”

Every physical asset has a lifespan, including the restrooms in our parks, signage, skatepark, lighting, HVAC systems, etc.

The longer we wait to address deferred maintenance, the more likely it is to lead to bigger issues requiring more financial resources to remedy.

Some deficiencies identified in the 2016 plan exist to this day. Deferred maintenance is taking its toll on public spaces. All while Parks and Recreation has taken on greater responsibility including maintaining park (street) strips, parking lots, beach accesses, The Villages at Sitka Woods property, and providing relief services (FEMA and Red Cross) to the community after the Echo Mountain Complex fires.

It is imperative for the City Council to consider if the community needs revealed in the System Plan are being supported and achieved by the City Management and the LC Parks and Recreation Department. If not, the Council and LCP&R need to understand how to support these goals and develop a plan to achieve them.

Lincoln City Parks and Recreation is a resource for residents and visitors via tourism. But that resource requires investment in order to remain competitive and achieve its objectives. This document lays out the challenges in front of you, and the community.

**From the 2016 plan – the following was a proposed timeline for implementation, based on priorities identified in the plan and other factors:**

**Short Term (1-5 years)**

- Develop new or refined conceptual master plans for high priority Core Service and Connectivity projects, including:
  - » Old school site community park in Taft - **Schooner Creek Discovery Park in process**
  - » D Lake neighborhood park – **Now under ELC with plans for Welcome Center in process**
  - » Nelscott neighborhood park
  - » Kirtsis Park/Community Center improvements, including teen center – **Kirtsis Park and Community Center improvements in process; teen center completed**
  - » Head to Bay Trail
- Secure funding sources for the same high priority projects
- Fill the City’s park and recreation director position – **completed**
- Implement improvements to selected existing park facilities
- Identify initial phase projects for priority core service parks, and/or for pocket or mini parks
- Begin development of high priority Core Service and Connectivity projects, as staffing and funding allow
- Continue to implement connectivity (street, trail and pathway projects) through the City’s capital improvement planning process and consistent with direction in the City’s 2015

Transportation System Plan, Americans with Disabilities Act (ADA) Plan and 2012 Walking and Biking Plan

- Identify land acquisition plans for medium term projects
- Incorporate plans for future park(s) in The Villages through the master planning process for the planned unit development

#### Medium Term (6-10 years)

- Develop high priority projects, pending availability of funding
- Develop new or refined conceptual master plans for remaining Core Service, Connectivity and Destination projects
- Secure funding sources for those same remaining projects
- Seek or respond to potential partnerships for recommended destination facilities
- Continue to implement Connectivity projects
- Continue to implement improvements to selected existing park facilities

#### Long Term (11-20 years)

- Complete recommended Core Service, Connectivity, and Destination projects, pending availability of funding
- Reassess system plan priorities and complete a targeted update of the plan to reflect updated priorities
- Continue to implement improvements to selected existing park facilities

## Path Forward

The path forward requires City Council, city government and community support. On May 24, 2021, the LC City Attorney and LCP&R Director presented funding source ideas to Council. Ideas include tax revenue, bond measures, Friends groups or Foundations, fundraising, etc.

A public bond could achieve the capital required for Nesika and Taft Parks, or to update or replace the Community Center.

In addition to deferred maintenance, Lincoln City deferred planning for Parks and Recreation assets. This must change.

Leadership on this issue from interested council members, Parks and Recreation board members, and the community is so important for our Parks and Recreation infrastructure to continue to serve the community into the future.

#### **Question of the Day is:**

How to pay for this when Parks Capital budget continues to be **\$200,000** or \$0 per year? That is

basically maintenance mode ... not investment mode.

- Parks and Recreation District?
- Bonds Issued by City?
- Lincoln City Contingency Funds Available?

## Financial and Key Metrics: (NEW RECOMMENDATIONS FROM BOARD GO HERE)

### **Expense Recovery Provided by Recreation Fees:**

- Fees increased in 2022, 2024 and 2025. Will increase again 7/1/26.
- Fees becoming more aligned with budgetary needs.

### **Capital Projects - Deferred Maintenance:**

### **Capital Projects – New Ammenities**

### **Long-Term Capital Needs (6+ years):**

### **Recreational Programming Guidelines:**

**NEW FLYER MAPPING ALL OUR P&R AREAS - TO COME**

Phase 3 Plant List

PLANTING SCHEDULE- OWNER FURNISHED PLANTS, CONTRACTOR INSTALLED

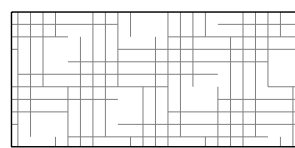
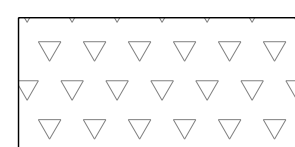
SYMBOL	BOTANICAL NAME	COMMON NAME	SIZE	SPACING	QUANTITY	DETAIL	NOTES
<b>GRASSLAND PLANTING</b>							
24,842 SF	<b>FORBS</b>						
	ACHILLEA MILLEFOLIUM	YARROW	10" PLUG	18" O.C.	453		OWNER-PROVIDED FORBS ARE BEING CONTRACT GROWN BY TILLAMOOK ESTUARIES PARTNERSHIP. PLANTS WILL BE DELIVERED TO THE SITE BY THE OWNER IN FALL OF 2025.  FORBS TO BE INTER-PLANTED WITH GRASSES IN GROUPS OF 5 TO 7 PLANTS PER TYPE. NO DISCERNABLE PATTERN.
	ANAPHALIS MARGARITACEA	PEARLY EVERLASTING	10" PLUG	18" O.C.	227		
	CAMASSIA QUAMASH	CAMAS	10" PLUG	18" O.C.	453		
	ERIGERON GLAUCUS	BEACH DAISY	10" PLUG	18" O.C.	227		
	EROPHYLLUM LANATUM	OREGON SUNSHINE	10" PLUG	18" O.C.	453		
	GRINDELIA INTEGRIFOLIA	WILLAMETTE GUMWEED	10" PLUG	18" O.C.	453		
	LUPINUS POLYPHYLLUS	LARGE-LEAFED LUPINE	10" PLUG	18" O.C.	453		
	PENSTEMON SERULATUS	COAST PENSTEMON	10" PLUG	18" O.C.	227		
	SOLIDAGO ELONGATA	MEADOW GOLDENROD	10" PLUG	18" O.C.	227		
	SOLIDAGO SPATHULATE	DUNE GOLDENROD	7" PLUG	18" O.C.	227		
	SYMPHYOTRICUM SUBSPICATUM	DOUGLAS ASTER	10" PLUG	18" O.C.	453		
	TANNACETUM BIPINNATUM	DUNE TANSY	7" PLUG	18" O.C.	453		
	VIOLA ADUNCA	EARLY BLUE VIOLET	7" PLUG	18" O.C.	226		
	<b>GRASSES</b>						
	CAREX PACHYSTACHYA	CHAMMISIO SEDGE	10" PLUG	18" O.C.	1015		OWNER-PROVIDED GRASSES ARE BEING CONTRACT GROWN BY TILLAMOOK ESTUARIES PARTNERSHIP. PLANTS WILL BE DELIVERED TO THE SITE BY THE OWNER IN FALL OF 2025.  GRASSES TO BE PLANTED IN GROUPS OF 15 TO 20 PLANTS PER TYPE. NO DISCERNABLE PATTERN.
	CAREX PANSA	MEADOW SEDGE	10" PLUG	18" O.C.	1015		
	DESCHAMPSIA CESPITOSA	TUFTED HAIR GRASS	10" PLUG	18" O.C.	2044		
	ELYMUS GLAUCUS	BLUE WILD RYE	10" PLUG	18" O.C.	1362		
	HORDEUM BRACHYANTHERUM	MEADOW BARLEY	10" PLUG	18" O.C.	1362		
<b>COASTAL FOREST PLANTING</b>							
3,982 SF	<b>SHRUBS</b>						
	BACCHARIS PILULARIS	COYOTE BRUSH	#1	24" O.C.	1,150		PLANTS WILL BE ORDERED BY THE CITY FROM TILLAMOOK ESTUARIES PARTNERSHIP IN NOVEMBER OF 2025.  PLANTS WILL BE DELIVERED TO THE SITE BY THE OWNER IN FALL OF 2025.  CONTRACTOR TO INSTALL PLANTS IN NATURAL MASSES OF 10 TO 15 PLANTS PER TYPE. NO DISCERNABLE PATTERN
	GAULTHERIA SHALLON	SALAL	#1	24" O.C.			
	PHYSOCARPUS CAPITATUS	PACIFIC NINEBARK	#1	24" O.C.			
	RIBES SANGUINEUM	RED-FLOWERING CURRANT	#1	24" O.C.			
	RUBUS PARVIFLORUS	THIMBLEBERRY	#1	24" O.C.			
	SPIRAEA DOUGLASII	ROSE SPIRAEA	#1	24" O.C.			
VACCINIUM OVATUM	EVERGREEN HUCKLEBERRY	#1	24" O.C.				

Total Forbs 4532

Total Grasses 6796

Total shrubs 1150

PLANTING SCHEDULE- OWNER FURNISHED PLANTS, CONTRACTOR INSTALLED

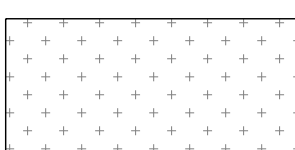
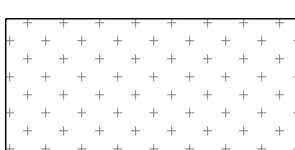
SYMBOL	BOTANICAL NAME	COMMON NAME	SIZE	SPACING	QUANTITY	DETAIL	NOTES
<b>STORMWATER PLANTING</b>							
2,856 SF	<b>SEDGES AND RUSHES</b>						
	CAREX LYNGBYEI	LYNGBYE'S SEDGE	10" PLUG	18" O.C.	1,466		PLANTS WILL BE ORDERED BY THE CITY FROM TILLAMOOK ESTUARIES PARTNERSHIP IN NOVEMBER OF 2026.  PLANTS WILL BE DELIVERED TO THE SITE BY THE OWNER IN FALL OF 2025.  CONTRACTOR TO INSTALL PLANTS IN NATURAL MASSES OF 10 TO 15 PLANTS PER TYPE. NO DISCERNABLE PATTERN
	CAREX OBNUPTA	SLOUGH SEDGE	10" PLUG	18" O.C.			
	CAREX UNILATERALIS	ONE-SIDED SEDGE	10" PLUG	18" O.C.			
	SCIRPUS MICROCARPUS	SMALL-FRUITED BULLRUSH	10" PLUG	18" O.C.			
	TYPHA LATIFOLIA	NARROW-LEAF CATTAIL	10" PLUG	18" O.C.			

PLANTING SCHEDULE - SEED (CONTRACTOR FURNISHED AND INSTALLED)

SYMBOL	SEED MIX	NOTES
<b>COASTAL GRASSLAND OVERSEEDING</b>		
24,842 SF	PT 400 NATIVE UPLAND MIX 1 LB PER 1000 SF  SOURCE: PT LAWN SEED HTTPS://PTLAWNSEED.COM/COLLECTIONS/NATIVE-SEEDS/PRODUCTS/PT-400-NATIVE-UPLAND-MIX?VARIANT=30829612	CONTRACTOR TO PROVIDE AND INSTALL SEED MIX  OVERSEED COASTAL GRASSLAND WITH SEED MIX AFTER PLANTING. HAND SCATTER SEEDS
<b>STORMWATER PLANTING OVERSEEDING</b>		
2,856 SF	PT 499 CLEAN WATER SERVICES NATIVE WET AREA MIX 4 OUNCES PER 1000 SF  SOURCE: PT LAWN SEED HTTPS://PTLAWNSEED.COM/COLLECTIONS/NATIVE-SEEDS/PRODUCTS/PT-499-CLEAN-WATER-SERVICES-NATIVE-WET-AREA-MIX?VARIANT=44063302975706	CONTRACTOR TO PROVIDE AND INSTALL SEED MIX  OVERSEED STORMWATER PLANTING AREAS WITH SEED MIX AFTER PLANTING. HAND SCATTER SEEDS

PLANTING SCHEDULE - TREES (CONTRACTOR FURNISHED AND INSTALLED)

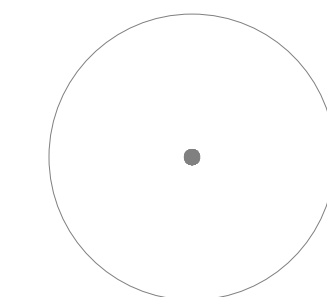
SYMBOL	BOTANICAL NAME	COMMON NAME	SIZE	QUANTITY	NOTES
<b>SHADE TREES</b>					
	TO BE SELECTED	TO BE SELECTED	2" CALIPER	37	BALLED AND BURLAPPED  4 of these will be small trees. All highlighted trees on plan will be large tree species

Trees will be selected from Phase 1 and 2 Tree lists

This Page:  
33 trees under 50'  
4 over 50'

REVISIONS	DESCRIPTION	BY	DATE

**DOWL**  
www.dowl.com  
963 SW Simpson Avenue, #200  
Bend, Oregon 97702  
541-386-4772

**understory**  
Understory Landscape Architecture, LLC  
330 SW Century Drive, Suite 405-207  
Bend, OR 97702  
Bend 541-241-2130 Portland 503-406-8624

SCHOONER CREEK DISCOVERY PARK  
PHASE 3  
PLANTING SCHEDULE  
LINCOLN COUNTY  
LINCOLN CITY, OR

PROJECT	14925
DATE	11.21.2025
60% SET	
© DOWL 2023	
SHEET	

L3.00

G:\Shared drives\Projects\2302 Toit Park\04 Documentation\01 CAD\1-PLNT-P.3.dwg PLOT DATE 2025-11-21 11:00 SAVED DATE 2025-11-21 10:14 USER: nick drummond

**GENERAL NOTES:**

**PLANTING NOTES:**

1. ALL FORBS, GRASSES, AND SHRUBS WILL BE OWNER PROVIDED, CONTRACTOR INSTALLED.
2. THE OWNER WILL ORDER PLANTS FROM TILLAMOOK ESTUARIES PARTNERSHIP AND ARRANGE DELIVERY TO THE SITE IN \_\_\_\_\_.
3. COORDINATE PLANT DELIVERY TIME WITH OWNER SO THAT ALL PLANTING PREP WILL BE COMPLETED PRIOR TO PLANT DELIVERY.
4. FIELD-VERIFY EXISTING IRRIGATION LOCATIONS WHEN PLANTING SUPPLEMENTAL FORBS IN PHASE 3.

**SOIL NOTES:**

1. EXISTING TOPSOIL TO BE SALVAGED FROM THE SITE OR PRESERVED IN PLACE.
2. A MINIMUM OF THREE SAMPLES OF EXISTING TOPSOIL TO BE TESTED BY A SOIL TESTING LAB PRIOR TO PLANTING.
3. SOIL TESTING LAB TO RECOMMEND ANY ORGANIC AND/OR INORGANIC SOIL AMENDMENTS NECESSARY TO ADD TO TOPSOIL FOR HEALTHY PLANT NATIVE GROWTH.
4. TOPSOIL TO BE AMENDED IN PLACE WITH LAB-RECOMMENDED AMENDMENTS PRIOR TO PLANTING. SEE SPECIFICATIONS.
5. THE COASTAL FOREST PLANTING AREA TO RECEIVE A MINIMUM DEPTH OF 2" OF FINE TEXTURED BARK MULCH, SEE SPECIFICATIONS.

**FENCING NOTES:**

1. PROVIDE TEMPORARY FENCING AROUND ALL PHASE 3 PLANTING AREAS. FENCING TO BE IN PLACE FOR 1-YEAR TO PROTECT PLANTS DURING ESTABLISHMENT.

**LEGEND**

SYMBOL	DESCRIPTION
	PROPERTY LINE
	LIMIT OF WORK
	WETLAND BOUNDARY
	EXISTING TREE TO BE PRESERVED

Phase 3 Planting Plan

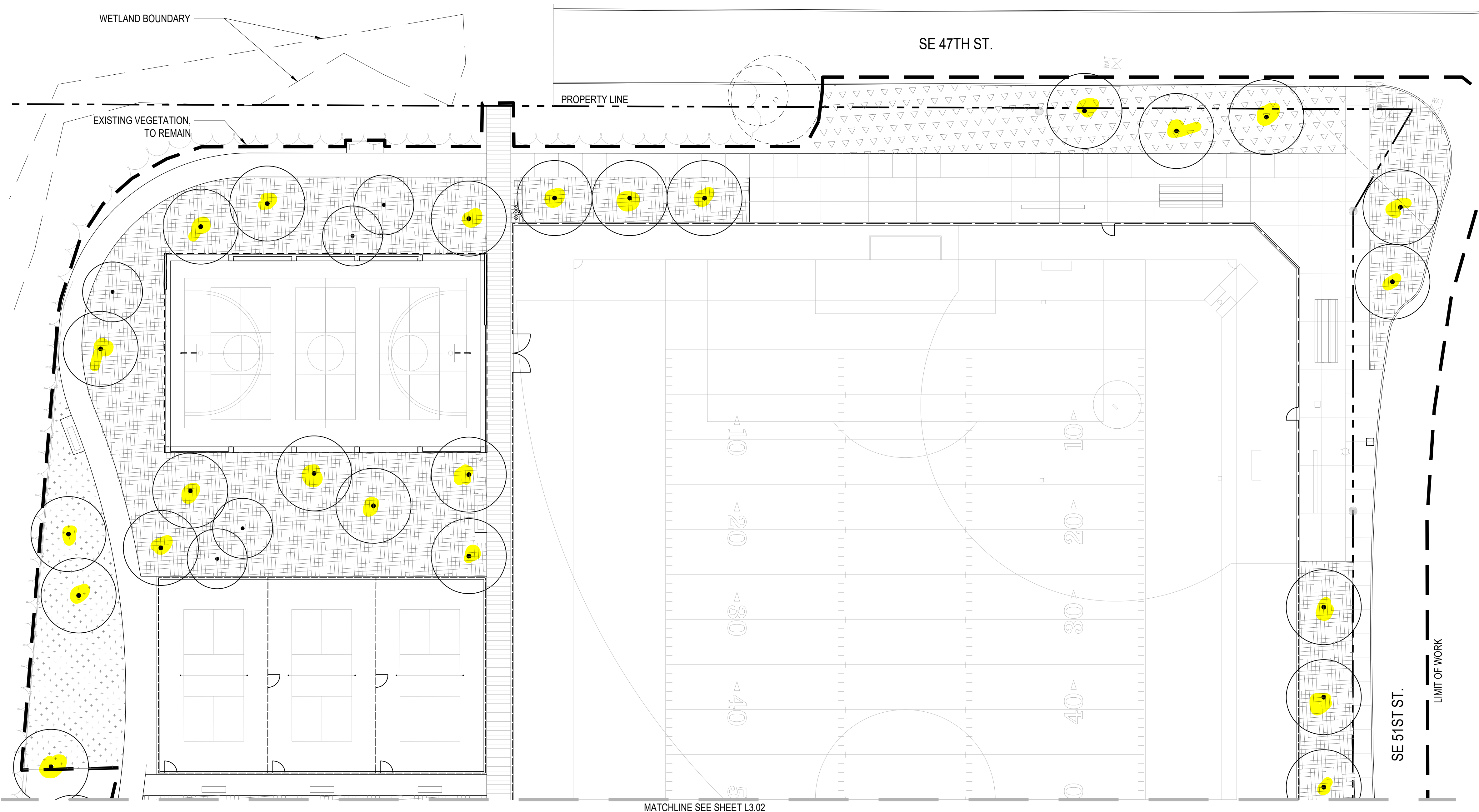

G:\Shored drives\Projects\2302 Taft Park\04 Documentation\01 CAD\1-PLNT-P3.dwg PLOT DATE 2025-11-21 11:02 SAVED DATE 2025-11-21 10:14 USER: nick drummond

REV	DATE	DESCRIPTION	BY

**DOWL**  
[WWW.DOWL.COM](http://WWW.DOWL.COM)  
 963 SW Simpson Avenue, #200  
 Bend, Oregon 97702  
 541-386-4772

**understory**  
 Understory Landscape Architecture, LLC  
 330 SW Century Drive, Suite 405-207  
 Bend, OR 97702  
 Bend 541-241-2130 Portland 503-466-8624

SCHOONER CREEK DISCOVERY PARK  
 PHASE 3  
**PLANTING PLAN - NORTH**  
 LINCOLN COUNTY  
 LINCOLN CITY, OR

PROJECT	14925
DATE	11.21.2025

60% SET  
 © DOWL 2023  
 SHEET

**L3.01**

**GENERAL NOTES:**

**PLANTING NOTES:**

1. ALL FORBS, GRASSES, AND SHRUBS WILL BE OWNER PROVIDED, CONTRACTOR INSTALLED.
2. THE OWNER WILL ORDER PLANTS FROM TILLAMOOK ESTUARIES PARTNERSHIP AND ARRANGE DELIVERY TO THE SITE IN \_\_\_\_\_.
3. COORDINATE PLANT DELIVERY TIME WITH OWNER SO THAT ALL PLANTING PREP WILL BE COMPLETED PRIOR TO PLANT DELIVERY.
4. FIELD-VERIFY EXISTING IRRIGATION LOCATIONS WHEN PLANTING SUPPLEMENTAL FORBS IN PHASE 3.

**SOIL NOTES:**

1. EXISTING TOPSOIL TO BE SALVAGED FROM THE SITE OR PRESERVED IN PLACE.
2. A MINIMUM OF THREE SAMPLES OF EXISTING TOPSOIL TO BE TESTED BY A SOIL TESTING LAB PRIOR TO PLANTING.
3. SOIL TESTING LAB TO RECOMMEND ANY ORGANIC AND/OR INORGANIC SOIL AMENDMENTS NECESSARY TO ADD TO TOPSOIL FOR HEALTHY PLANT NATIVE GROWTH.
4. TOPSOIL TO BE AMENDED IN PLACE WITH LAB-RECOMMENDED AMENDMENTS PRIOR TO PLANTING. SEE SPECIFICATIONS.
5. THE COASTAL FOREST PLANTING AREA TO RECEIVE A MINIMUM DEPTH OF 2" OF FINE TEXTURED BARK MULCH, SEE SPECIFICATIONS.

**FENCING NOTES:**

1. PROVIDE TEMPORARY FENCING AROUND ALL PHASE 3 PLANTING AREAS. FENCING TO BE IN PLACE FOR 1-YEAR TO PROTECT PLANTS DURING ESTABLISHMENT.

**LEGEND**

SYMBOL	DESCRIPTION
---	PROPERTY LINE
---	LIMIT OF WORK
---	WETLAND BOUNDARY
○	EXISTING TREE TO BE PRESERVED

Phase 3 Planting Plan

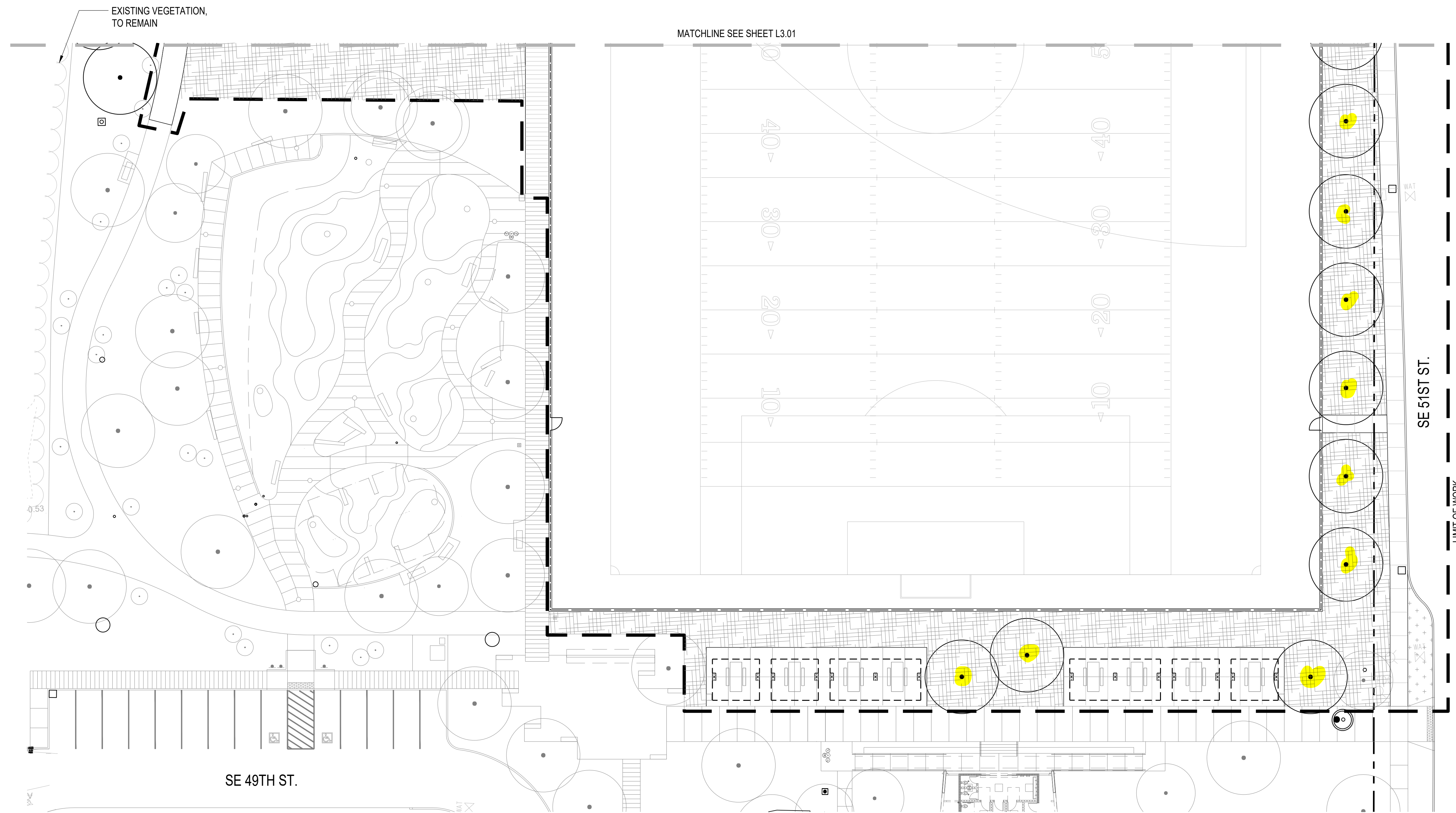

REV	DATE	DESCRIPTION	BY

G:\Shared drives\Projects\2302 Taft Park\04 Documentation\01 CAD\1-PLNT-P3.dwg PLOT DATE 2025-11-21 10:14 USER: nick drummond

**DOWL**  
 963 SW Simpson Avenue, #200  
 Bend, Oregon 97702  
 541-386-4772  
[www.dowl.com](http://www.dowl.com)

**understory**  
 Understory Landscape Architecture, LLC  
 330 SW Century Drive, Suite 403-237  
 Bend, OR 97702  
 Bend 541-241-2130 Portland 503-466-8624

SCHOONER CREEK DISCOVERY PARK  
 PHASE 3  
**PLANTING PLAN - SOUTH**  
 LINCOLN COUNTY  
 LINCOLN CITY, OR

PROJECT 14925  
 DATE 11.21.2025  
 60% SET

© DOWL 2023  
 SHEET

**L3.02**